

SAFI Installation Guide

SAVE THESE INSTRUCTIONS



BEFORE YOU BEGIN

Read and follow all safety instructions



WARNING

RISK OF FIRE, EXPLOSION AND ELECTRIC SHOCK

- This product should be installed, inspected, and maintained by a qualified electrician only, in accordance with the NEC (National Electric Code) and all local codes.
- Turn off electrical power before inspection, installation or removal.
- Use only UL (or other NRTL) approved wire for input/output connections. Minimum size 18 AWG or 14 AWG for continuous runs.
- Make sure LEDs and drivers are cool to touch when performing maintenance. Make sure the supply voltage is the same as the rated voltage of the luminaire.
- Do not install in a hazardous atmosphere, except where the ambient temperature does not exceed the rated operating temperature of the fixture.
- Keep tightly closed when in operation.



Prepare Electrical Wiring



Electrical Requirements

- The LED driver must be supplied with the voltage specified on the product label and connected to an individual, properly grounded branch circuit protected by a 20 Ampere circuit breaker. Use min. 75°C supply.



Grounding Instructions

- The grounding and bonding of the overall system shall be done in accordance with NEC Article 600 and local codes.

Before starting:

- Ensure that the supply power is shut off.
- Unpack the fixture and ensure that there are no damaged or missing parts.

Tools Required:

#2 Phillips Screw Driver
8mm Hex Socket
Wire Strippers
Wire Cutters

Wall Mount Installation

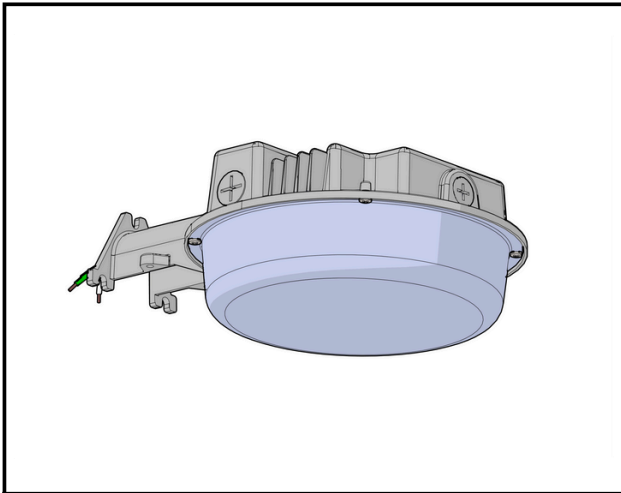

Step 1: Select a suitable mounting location near a junction box. The hardware provided is for mounting to a wood structure, however if mounting to another type of surface use the appropriate hardware.

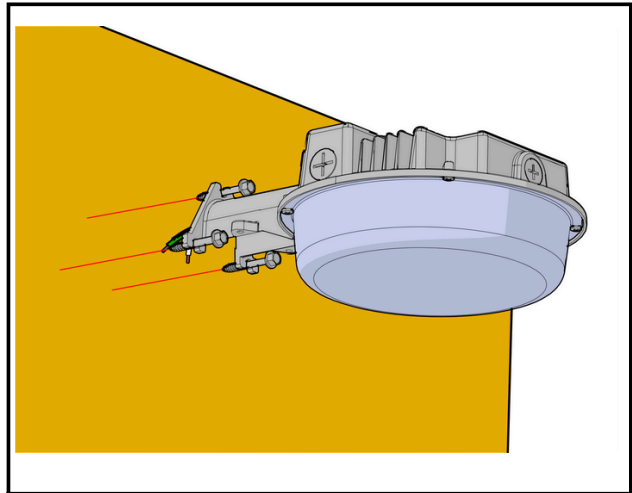

Step 2: Mark and drill the appropriate holes for the fixture screw slots. Attach fixture to mounting surface using the included lag screws, or other appropriate hardware. Wire the fixture according to Page 4.

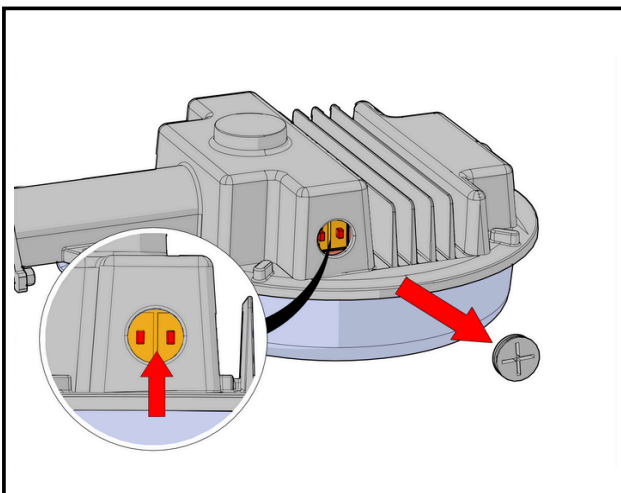

Step 3: Remove the side conduit plug to access the FAO module. Slide each switch to the desired setting and replace the conduit plug securely.

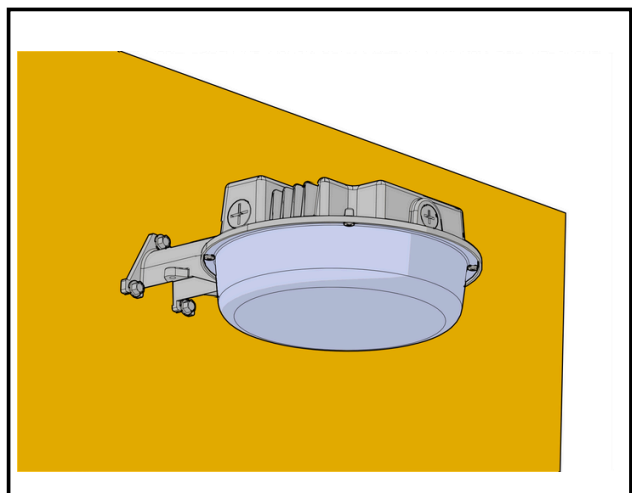

Step 4: Turn the supply power back on and ensure the fixture functions properly.

Before starting:

- Ensure that the supply power is shut off.
- Unpack the fixture and ensure that there are no damaged or missing parts

Tools Required:

#2 Phillips Screw Driver
 #2 Flat Head Screw Driver
 8mm and 10mm Hex Socket
 Wire Strippers
 Wire Cutters

Pole Mount Installation

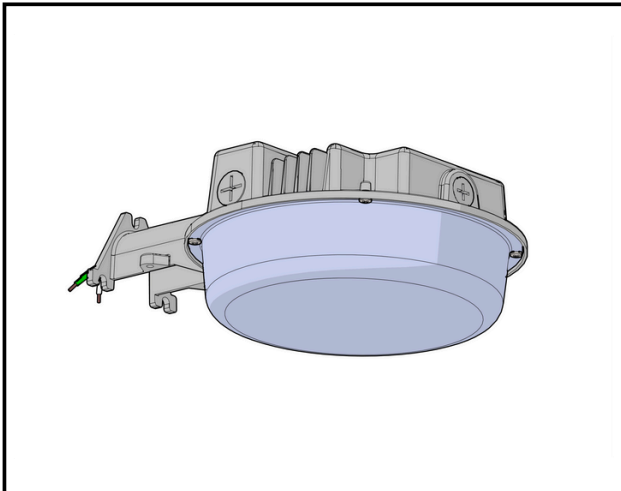

Step 1: Select a suitable mounting location near a junction box. The hardware provided is for mounting to a wood structure, however if mounting to another type of surface use the appropriate hardware.

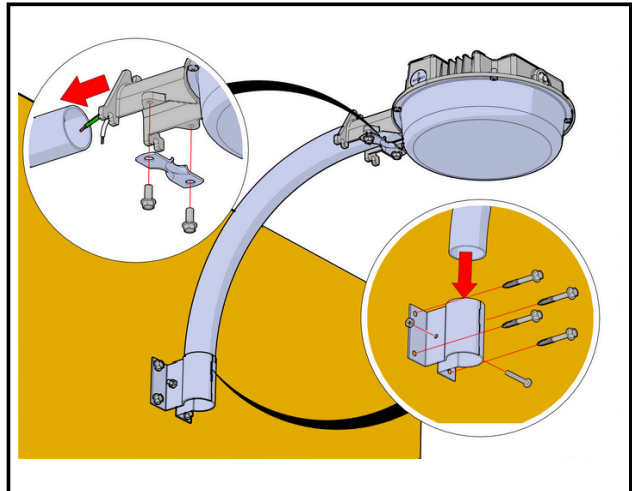

Step 2: Mark and drill the holes for the pole arm bracket. Attach the assembly to mounting surface using the included lag screws, or other appropriate hardware. Wire the fixture according to Page 4.

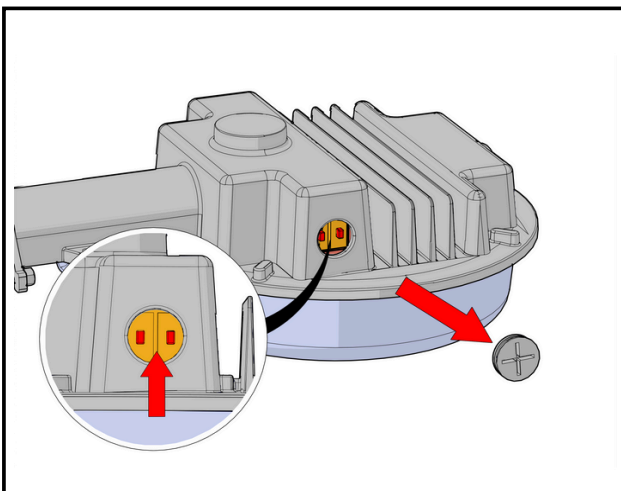

Step 3: Remove the side conduit plug to access the FAO module. Slide each switch to the desired setting and replace the conduit plug securely.

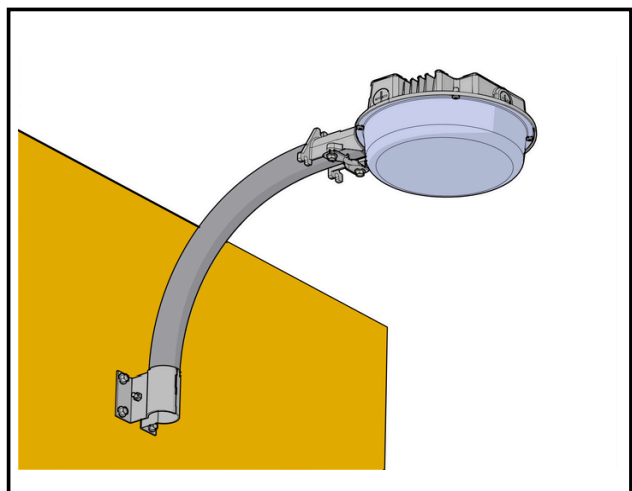

Step 4: Turn the supply power back on and ensure the fixture functions properly.

Electrical Wiring Diagram

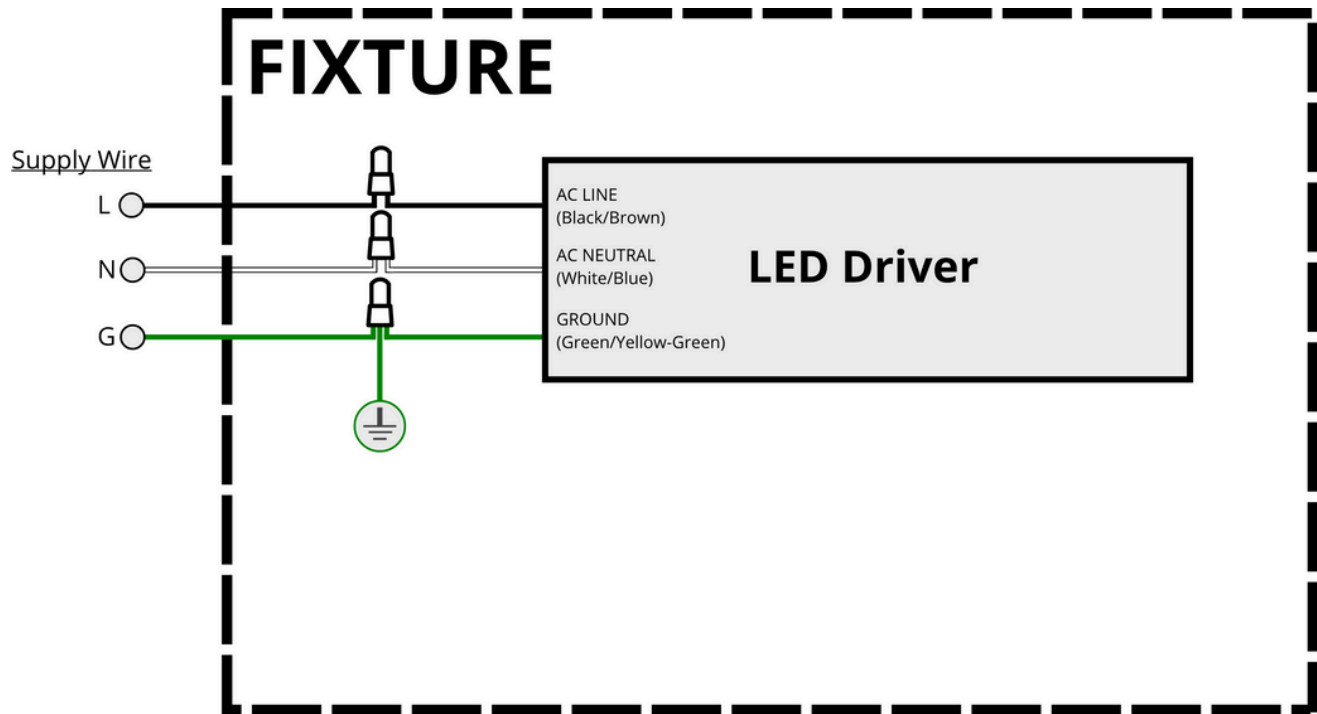

Note: This fixture is provided with a power cord. When wiring to a junction box, a liquid-tight connector must be used to prevent water ingress.